

FILAMATIC

Type FUS Filling Units

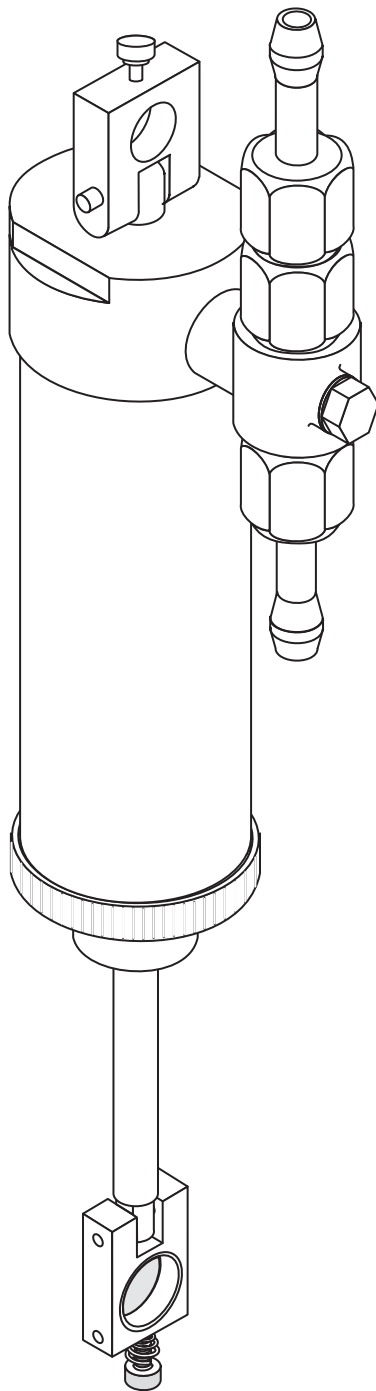

Capacities: 0.05mL to 1100mL

FUS: These Filling Units are designed for dispensing free-flowing liquids such as alcohol, perfumes, and solutions. The fill volumes range from 0.05mL to 1100mL with an accuracy of 0.5%. Adjustable Teflon piston rings take all of the wear to provide many years of dispensing with no need to replace the stainless steel components. O-Ring piston seals are also available. The entire mechanism is easily disassembled for cleaning.

Piston Seal Options

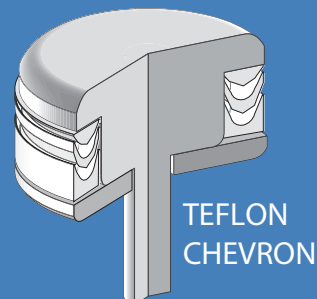

The most versatile and durable piston seal. Normal wear is compensated by tightening an adjustment stem.

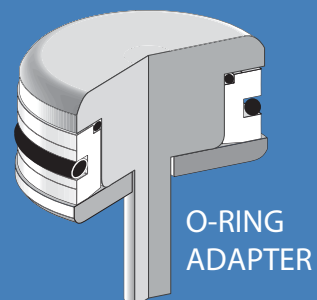

Replaces chevron style and offers a more sanitary design.